

# 5" & 6" LED RETROFIT LUMINAIRE WITH INTEGRATED TRIM

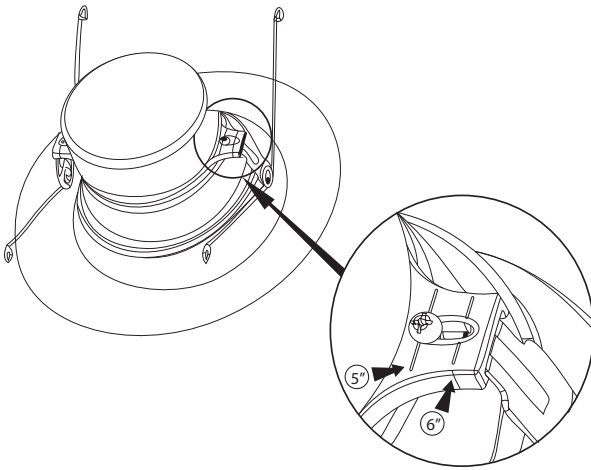

## HOUSINGS:

This recessed luminaire has E26 Edison screw-base and is UL listed for installation in shallow recessed housing series.

### HALO:

H71CT, H71CAT I CATNB, H7RICAT, H7RICT, H7UICAT, H7UICT, h750RICAT, H750IC, H27ICT, H27RICAT, H5RICAT, H750TCP.

### ALO-PRO:

EI 700, EI700ATNB, EI1700NB, Ei700RAT, EI700U, Ei700UAT, Ei2700, EI2700AT, EI500AT, Ei500RAT.

Juno:IC22,IC22R,IC22W,IC22WS,IC23,IC23W, IC21,IC21R,IC25,IC25W,IC25S.

Capri:CRI,PR1,QLT,R9ASIC.

Li-honoa:L7X, L7XP.

Thomas:PS1

Commercial Electric: H3(C7ICA)

Elco: EL7ICA(EL7ICA)

For additional product and ordering information, please refer the latest manufacturing specification.

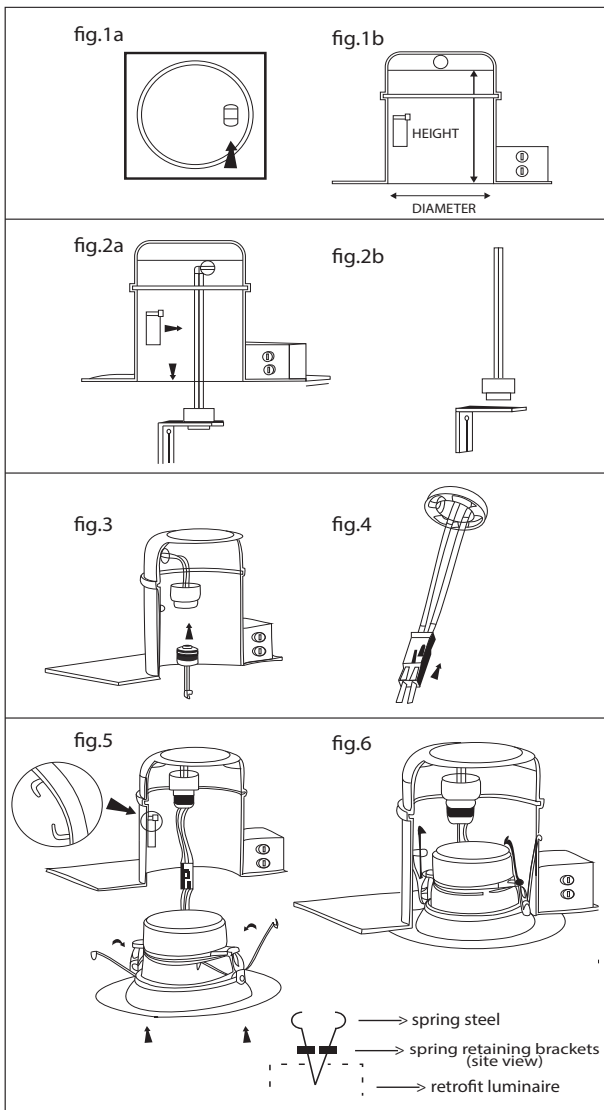

## QUICK INSTALLATION GUIDE

**Step 1.** Make sure the POWER IS TURNED OFF at the source to the recessed housings inside which you are installing the products. Once power has been turned off, remove existing the trim and bulb.

**Step 2.** Unscrew the lamp socket mounting bracket inside the recessed housing (fig.2a). Unclip the lamp socket from the bracket, and discard the bracket (fig. 2b).

**Step 3.** Screw Edison base adaptor into the socket (fig.3).

**Step 4.** Plug the female connector of the retrofit kit in to the male connector of the socket adaptor (fig.4).

**Step 5.** Squeeze the springs of the retrofit of the retrofit kit and insert them inside the housing retaining bracket (fig. 5). Carefully tuck all wire inside the can and gently push the retrofit kit up into recessed housings. (fig.6).

## HOUSING COMPATIBILITY

Compatible with most standard 5" and 6" insulated and non-insulated-housings that have spring retaining brackets inside (fig.5). Compatibility of housing may be determined by measurement of the housing as detailed in (fig.1b).

## 5" & 6" LED RETROFIT LUMINAIRE WITH INTEGRATED TRIM

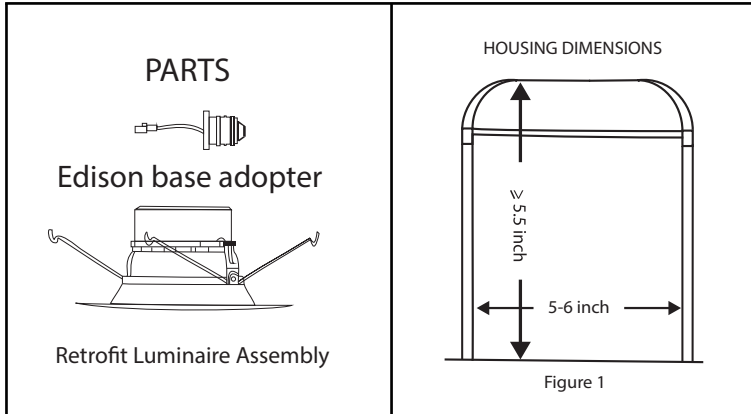

### INSTALLATION INSTIONS RECESSED HOUSING AND DIMMER COMPATIBILITY

- LED Retrofit Luminaire is designed to install in standard 6" in 5" recessed down light housing.
- Lutron and Leviton dimmer recommended.
- Compatibility of housing not on this list may be determined by measurement of the housing as detailed in the attached drawing (Figure 1).

### IMPORTANT SAFETY INSTRUCTIONS

- **WARNING**-Risk of the or electric shock. LED Retrofit Kit installation requires knowledge of electrical system. If not qualified, do not attempt installation. Contact a qualified electrician.
- **WARING** – Risk of electrical shock. Install these kids only in the housings with feature and dimensions shown in the drawings.
- **WARING**- To prevent wiring damage or abrasion, do not expose wiring to edge of sheet mental or other sharp object.
- Do not make or alter any open holes in wiring enclosure or electrical components during kit installation.
- **WARING-RISK OF FIRE OF ELECTRIC SHOCK. DO NOT ALTER. RELOCATE OR REMOVE WIRING,**
- **LAMP HOLDERS, POWER SUPPLY, OR ANY OTHER ELECTRICAL COMPONENTS.**
- **WARING-RISK OF FIRE OF ELECTRICAL SHOCK. INSTALLATION OF THIS RETROFIT ASSEMBLY REQUIRES A PERSON FAMILIAR WITH THE CONSTRAC-TION AND OPERATION OF THE LUMINAIRE'S ELEC-TRICAL SYSTEM AND THE HAZARD INVOLVED. IF NOT QUALIFIED , DO NOT ATTEMPT INSTALLATION. CON-TACT A QUALIFIED ELECTRICIAN.**
- **COUTION: SHOCK AND FIRE HAZAR. DO NOT USE WHEN ENCLOSURE IS BROKEN.**
- **SUTABLE FOR USE IN ENCLOSED RECESSED LUMI-NAIRES.**
- **MIN. LAMP COMPARTMENT DIMENSIONS\_ 5 (D)\_X 4.5(H) INCH"** where D is minimum diameter and H is minimum height of Listed Recessed luminaire Compartment, as applicable.
- **SUITABLE FOR DAMP LOCATIONS.**
- **SUITABLE FOT TYOE IC or SUITABLE FOR TYPE NON-IC.**

- **WARRANTY:**We offer 5 years limited warranty. As with any electrical installation, a qualified electrician must ensure compatibility of use with a particular housing; this includes all applicable national and local electrical and building codes. Installer is responsible to securely retain the LED Module in a housing at time of installation.

### NOTE:

1. Before starting installation, please read it leaflet and keep it for future reference.
2. To avoid possible electrical shock, be sure that power is turned off at fuse box or circuit before installing or servicing fixture.
3. During installation do not let the product surface rub against other hard objects or drop on the floor, otherwise the product may be damaged.
4. Conductors (power wires) connecting the fixture must be rated minimum 90 C to reduce risk of five uncertain, consult an electrician.
5. The luminaire must be securely mounted, any bare wires of the power cord must be properly insulated to prevent electrical hazards.
6. For indoor use only, suitable for damp locations do not left light and its power supply and contact water and other liquids in order to avoid leakage, electric shock situations.
7. Installation of any recessed lighting lumi-naire must meet local electrical code. This code sets the wiring standards for your locality and should be carefully studied before starting.
8. Protect the light from dust and dirt when painting or during construction.
9. Clean with a soft damp cloth only, do not use any chemical cleaners.